

ATTACHMENT B

Initial Layout Draft

Victorville Fire Department - Type I - 14' Module

Front Wall

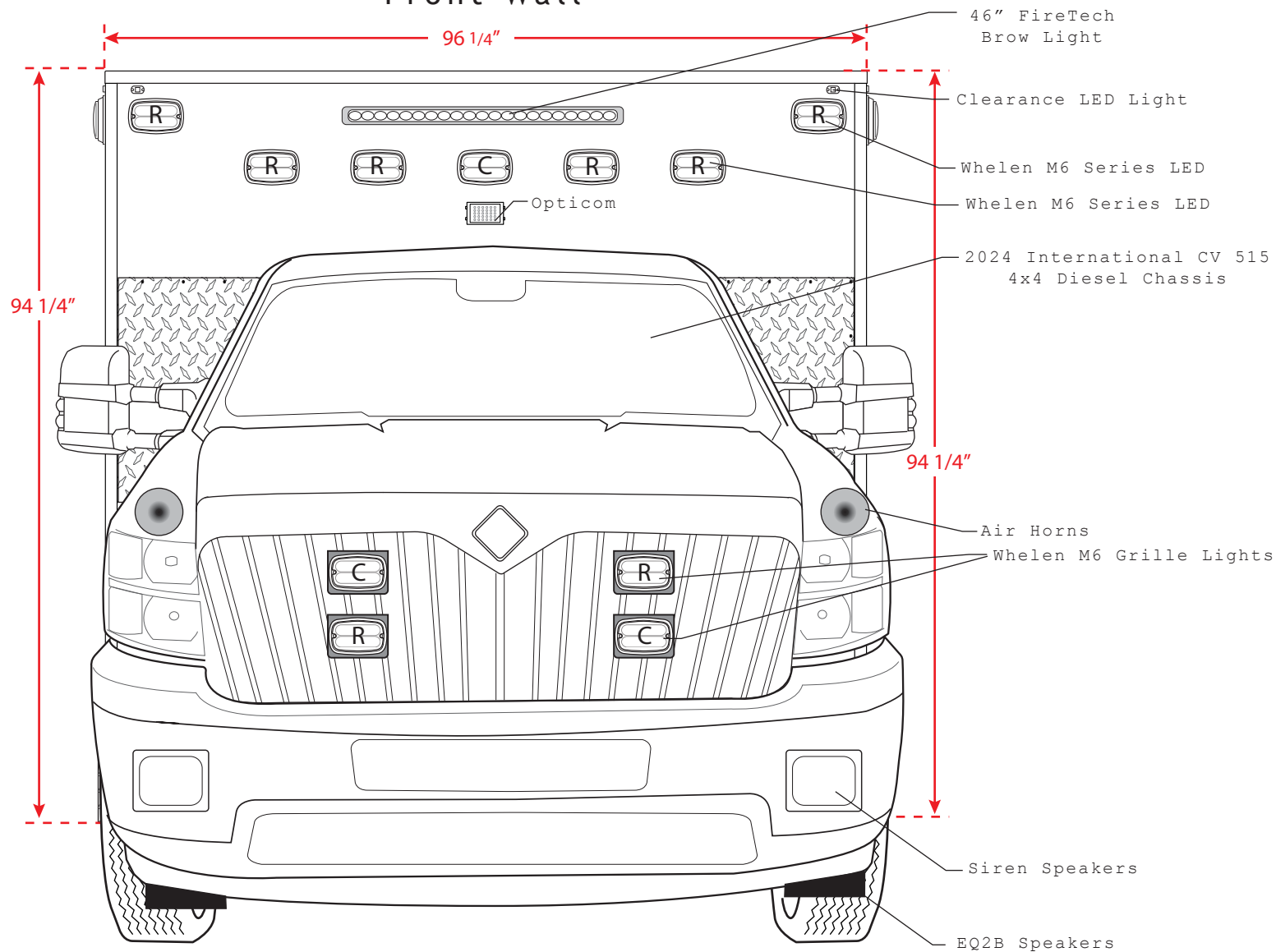

Note: Dimensions are Tube to Tube and Approximate

toll free: (888) 372-9371
 main: (713) 772-5511
 fax: (713) 995-0541
 www.frazerbilt.com

Main: 7227 A Rampart
 Houston, TX 77081
 Shipping: 7227 Rampart
 Houston, TX 77081
 Mailing: P.O. Box 5000
 Bellaire, TX 77402-5000

Print No. 10190 version 1 - Page 1 of 10

This drawing and all information thereon is the property of Frazer, Ltd. It is confidential and may not be reproduced or copied, whole or in part or be disclosed to others, without the specific written approval of Frazer, Ltd. It may be used solely for the purpose specified in writing and is subject to return upon demand.

DRAFT BY: WB
 QC BY: AS

Victorville Fire Department - Type I - 14' Module

Driver Side Wall

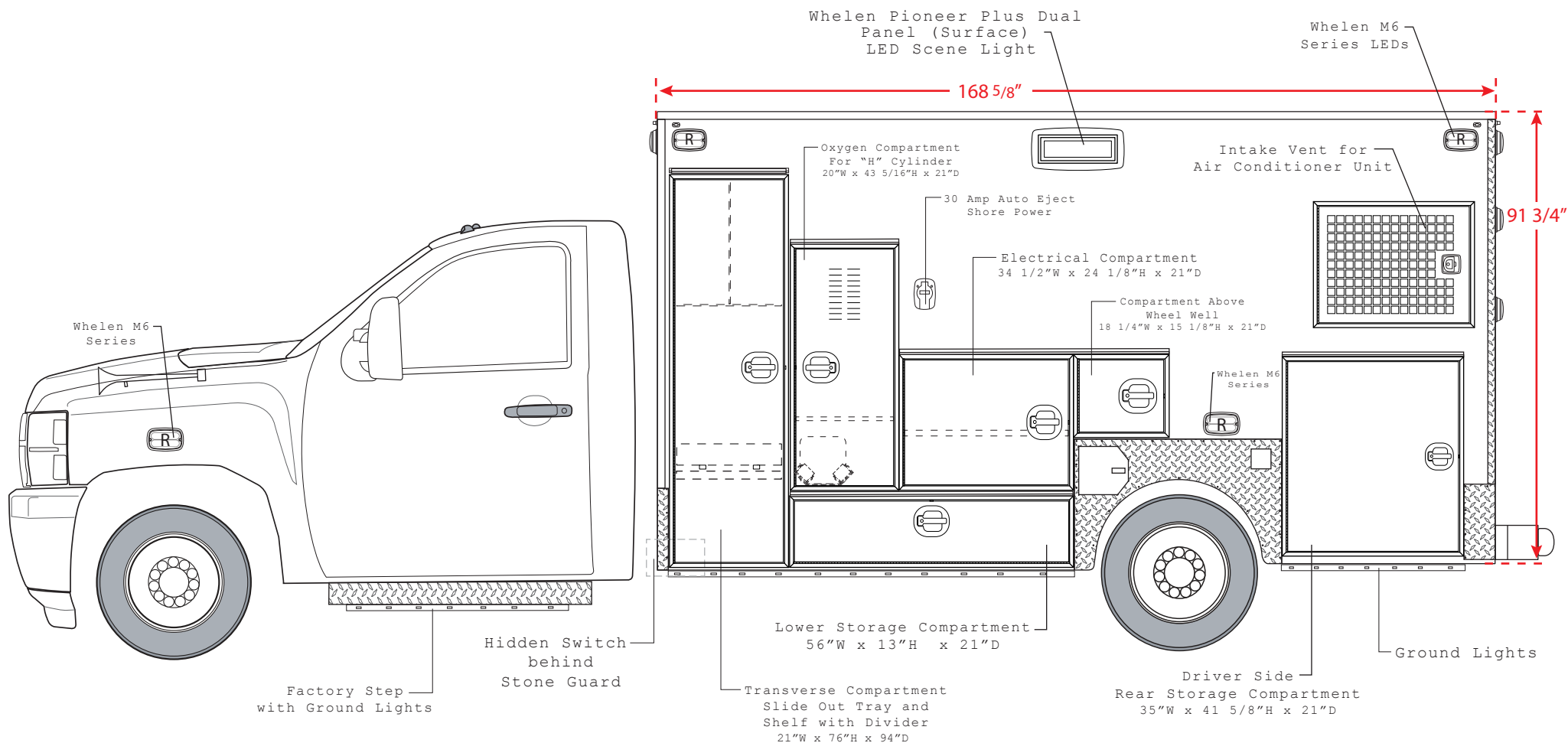

Note: Dimensions are Tube to Tube and Approximate

toll free: (888) 372-9371
 main: (713) 772-5511
 fax: (713) 995-0541
 www.frazerbilt.com

Main: 7227 A Rampart
 Houston, TX 77081
 Shipping: 7227 Rampart
 Houston, TX 77081
 Mailing: P.O. Box 5000
 Bellaire, TX 77402-5000

Print No. 10190 version 1 - Page 2 of 10

This drawing and all information thereon is the property of Frazer, Ltd. It is confidential and may not be reproduced or copied, whole or in part or be disclosed to others, without the specific written approval of Frazer, Ltd. It may be used solely for the purpose specified in writing and is subject to return upon demand.

DRAFT By: WB
 QC By: AS

Victorville Fire Department - Type I - 14' Module

Passenger's Side Wall

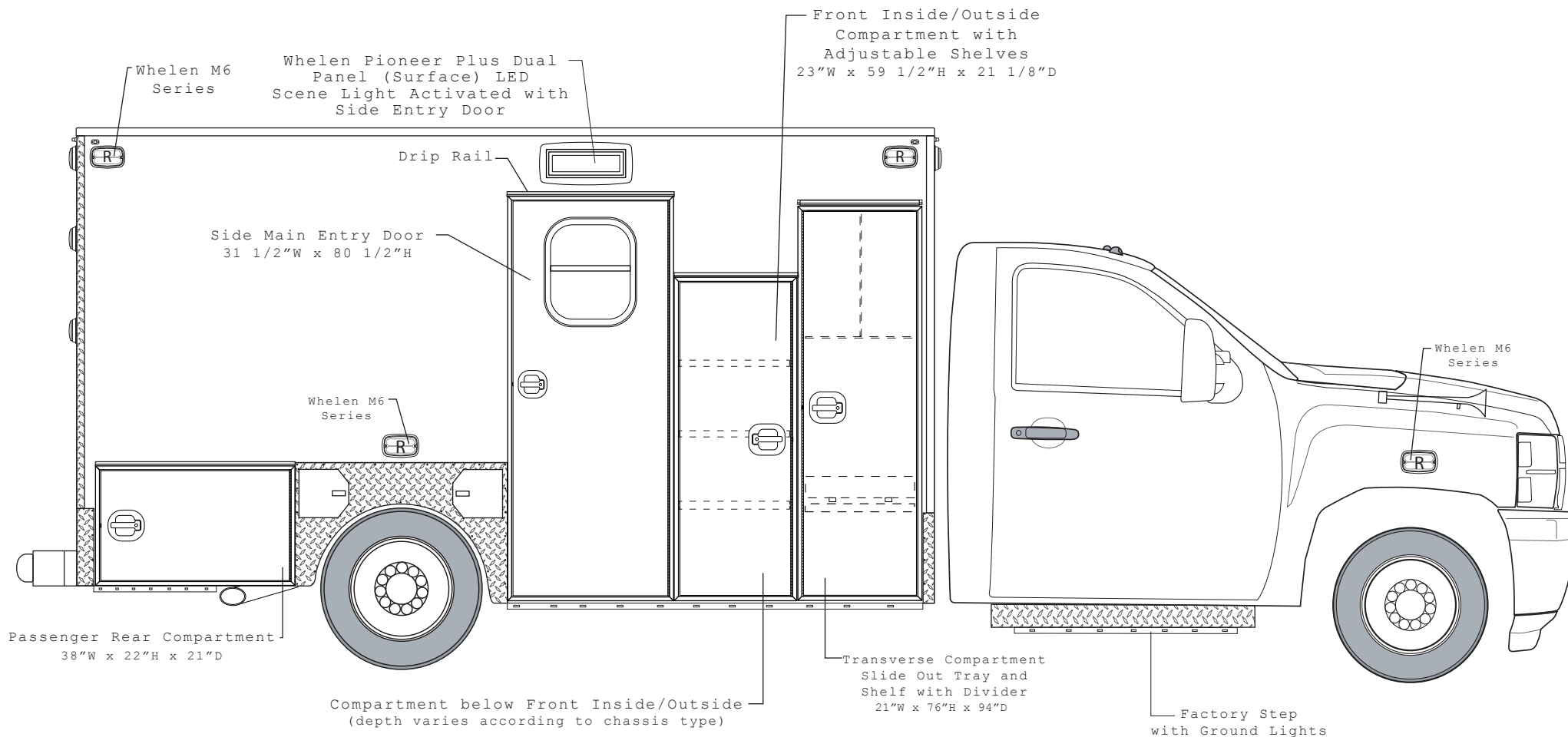

Note: Dimensions are Tube to Tube and Approximate

toll free: (888) 372-9371
main: (713) 772-5511
fax: (713) 995-0541
www.frazerbilt.com

Main: 7227 A Rampart
Houston, TX 77081
Shipping: 7227 Rampart
Houston, TX 77081
Mailing: P.O. Box 5000
Bellaire, TX 77402-5000

Print No. 10190 version 1 - Page 3 of 10

This drawing and all information thereon is the property of Frazer, Ltd. It is confidential and may not be reproduced or copied, whole or in part or be disclosed to others, without the specific written approval of Frazer, Ltd. It may be used solely for the purpose specified in writing and is subject to return upon demand.

DRAFT BY: WB
QC BY: AS

Victorville Fire Department - Type I - 14' Module

Rear Wall

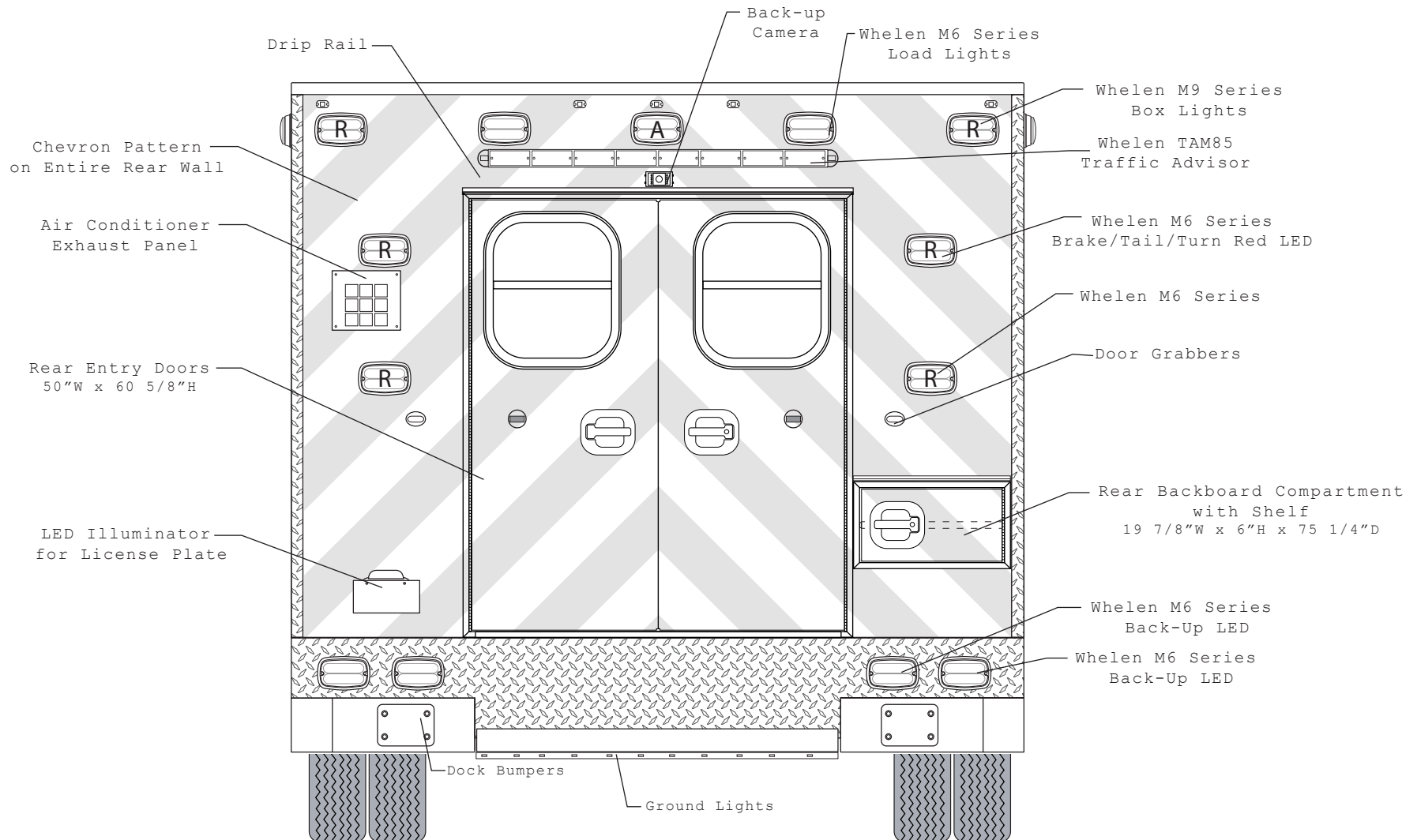

Note: Dimensions are Tube to Tube and Approximate

toll free: (888) 372-9371
 main: (713) 772-5511
 fax: (713) 995-0541
 www.frazerbilt.com

Main: 7227 A Rampart
 Houston, TX 77081
 Shipping: 7227 Rampart
 Houston, TX 77081
 Mailing: P.O. Box 5000
 Bellaire, TX 77402-5000

Print No. 10190 version 1 - Page 4 of 10

This drawing and all information thereon is the property of Frazer, Ltd. It is confidential and may not be reproduced or copied, whole or in part or be disclosed to others, without the specific written approval of Frazer, Ltd. It may be used solely for the purpose specified in writing and is subject to return upon demand.

DRAFT BY: WB
 QC BY: AS

Victorville Fire Department - Type I - 14' Module

Interior Front Wall

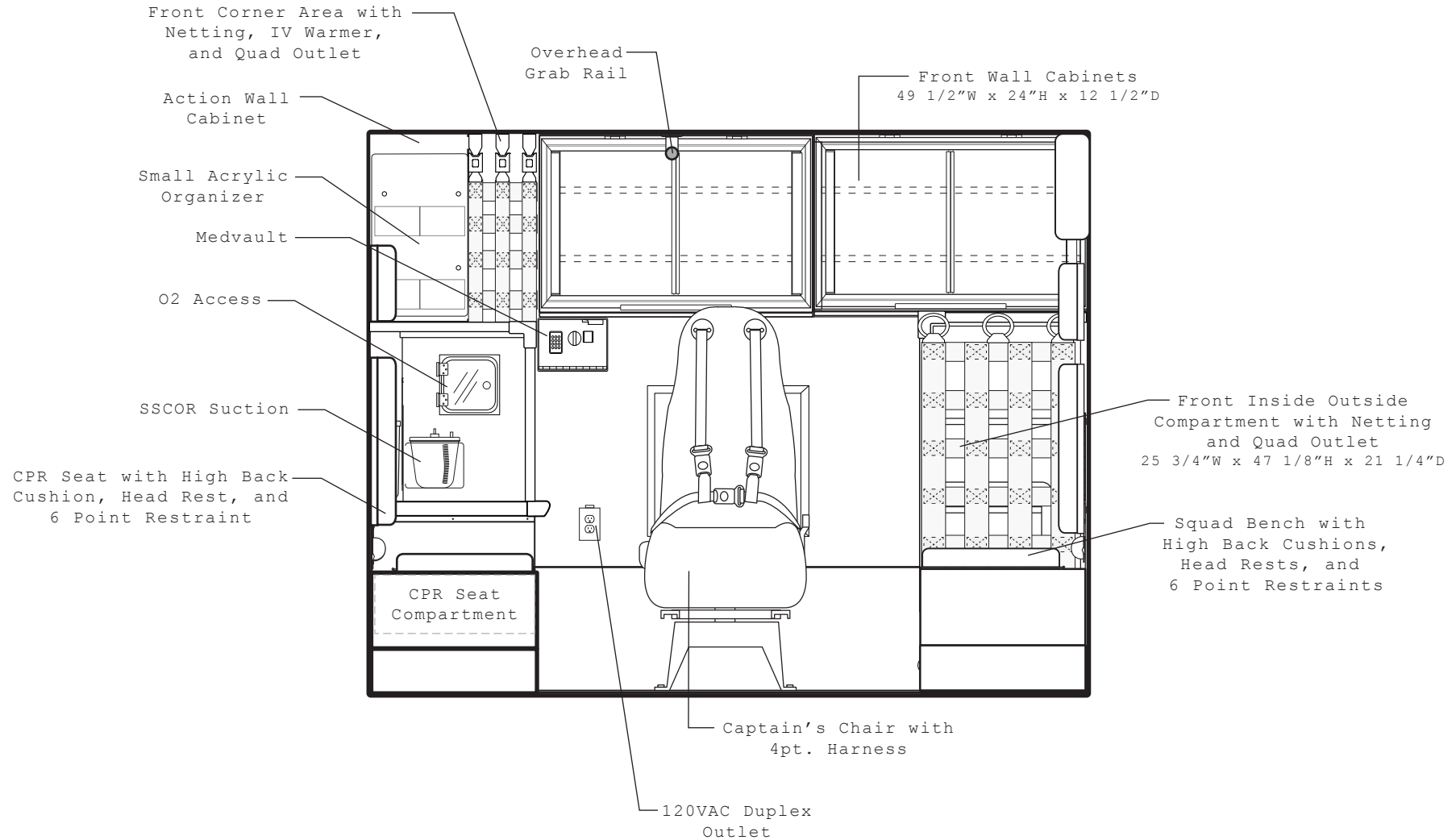

Note: Dimensions are Approximate

toll free: (888) 372-9371
main: (713) 772-5511
fax: (713) 995-0541
www.frazerbilt.com

Main: 7227 A Rampart
Houston, TX 77081
Shipping: 7227 Rampart
Houston, TX 77081
Mail: P.O. Box 5000
Bellaire, TX 77402-5000

Print No. 10190 version 1 - Page 5 of 10

This drawing and all information thereon is the property of Frazer, Ltd. It is confidential and may not be reproduced or copied, whole or in part or be disclosed to others, without the specific written approval of Frazer, Ltd. It may be used solely for the purpose specified in writing and is subject to return upon demand.

DRAFT BY: WB
QC BY: AS

August 16, 2023

Victorville Fire Department - Type I - 14' Module

Interior Driver Side Wall

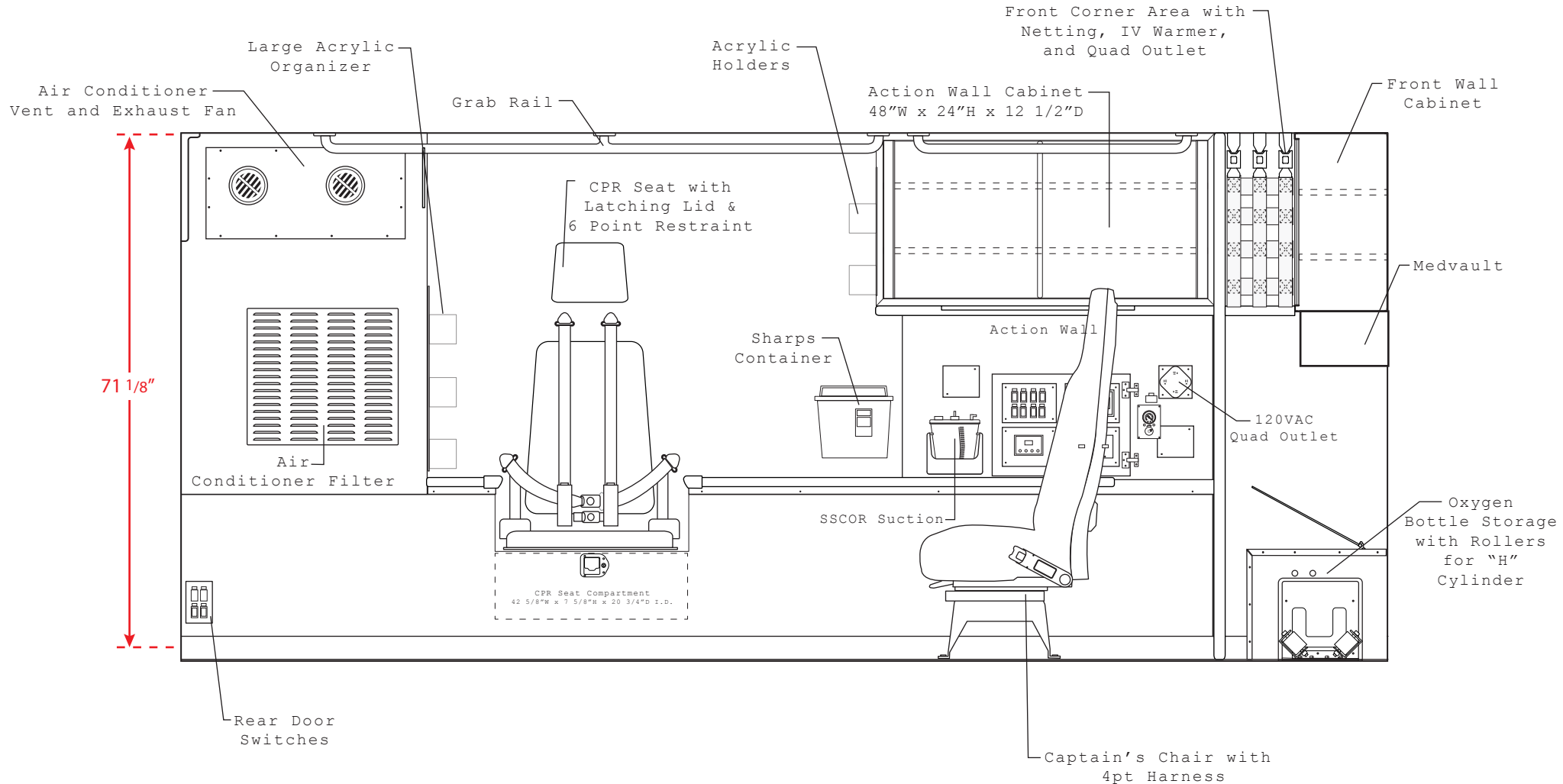

Note: Dimensions are Approximate

toll free: (888) 372-9371
 main: (713) 772-5511
 fax: (713) 995-0541
 www.frazerbilt.com

Main: 7227 A Rampart
 Houston, TX 77081
 Shipping: 7227 Rampart
 Houston, TX 77081
 Mailing: P.O. Box 5000
 Bellaire, TX 77402-5000

Print No. 10190 version 1 - Page 6 of 10

This drawing and all information thereon is the property of Frazer, Ltd. It is confidential and may not be reproduced or copied, whole or in part or be disclosed to others, without the specific written approval of Frazer, Ltd. It may be used solely for the purpose specified in writing and is subject to return upon demand.

DRAFT BY: WB
 QC BY: AS

August 16, 2023

Victorville Fire Department - Type I - 14' Module

Interior Passenger Side Wall

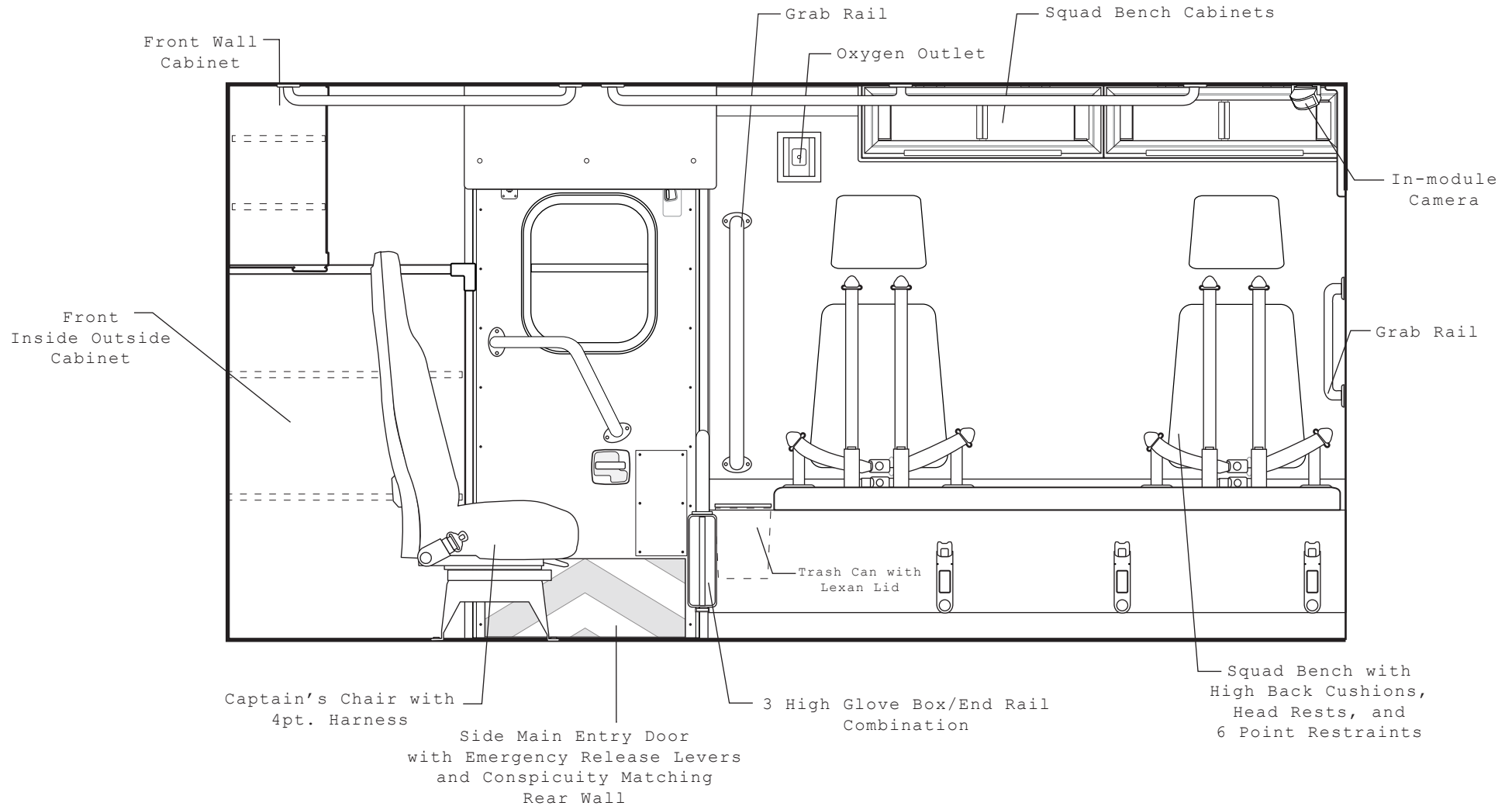

Note: Dimensions are Approximate

toll free: (888) 372-9371
 main: (713) 772-5511
 fax: (713) 995-0541
 www.frazerbilt.com

Main: 7227 A Rampart
 Houston, TX 77081
 Shipping: 7227 Rampart
 Houston, TX 77081
 Mailing: P.O. Box 5000
 Bellaire, TX 77402-5000

Print No. 10190 version 1 - Page 7 of 10

This drawing and all information thereon is the property of Frazer, Ltd. It is confidential and may not be reproduced or copied, whole or in part or be disclosed to others, without the specific written approval of Frazer, Ltd. It may be used solely for the purpose specified in writing and is subject to return upon demand.

DRAFT BY: WB
 QC BY: AS

Victorville Fire Department - Type I - 14' Module

Interior Rear Wall

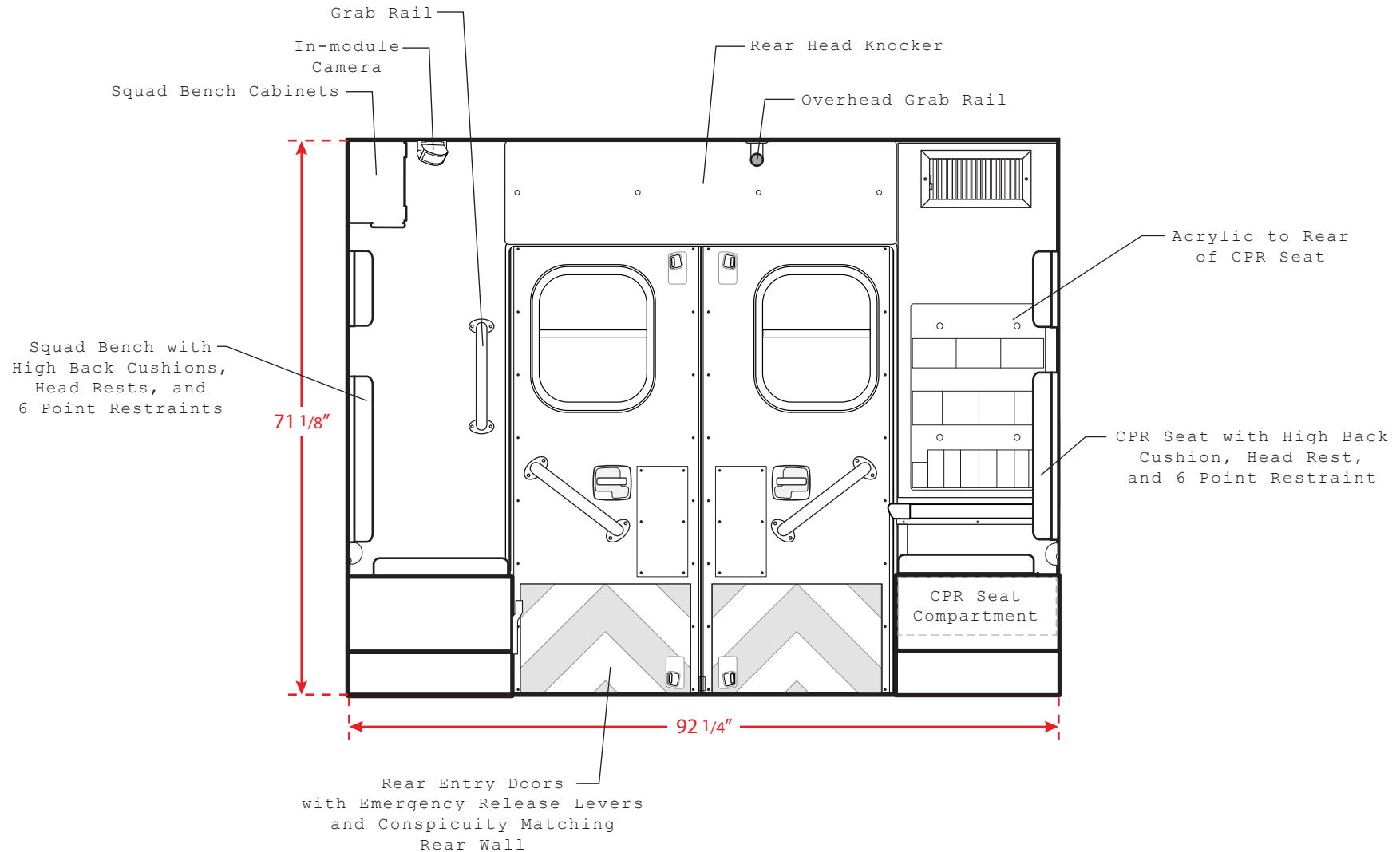

Note: Dimensions are Approximate

toll free: (888) 372-9371
 main: (713) 772-5511
 fax: (713) 995-0541
 www.frazerbilt.com

Main: 7227 A Rampart
 Houston, TX 77081
 Shipping: 7227 Rampart
 Houston, TX 77081
 Mailing: P.O. Box 5000
 Bellaire, TX 77402-5000

Print No. 10190 version 1 - Page 8 of 10

This drawing and all information thereon is the property of Frazer, Ltd. It is confidential and may not be reproduced or copied, whole or in part or be disclosed to others, without the specific written approval of Frazer, Ltd. It may be used solely for the purpose specified in writing and is subject to return upon demand.

DRAFT BY: WB
 QC BY: AS

Victorville Fire Department - Type I - 14' Module

Interior Ceiling

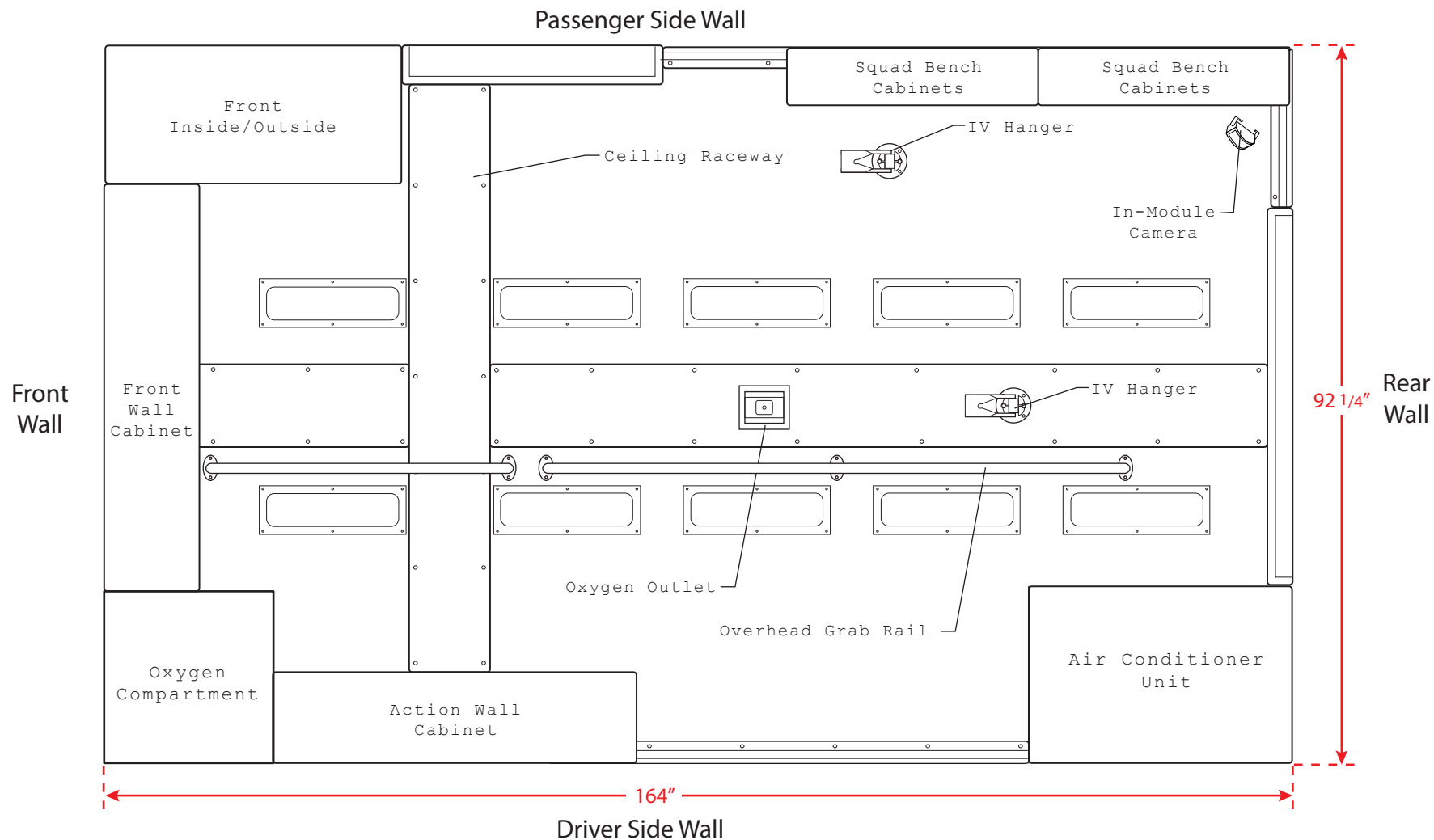

Note: Dimensions are Approximate

toll free: (888) 372-9371
main: (713) 772-5511
fax: (713) 995-0541
www.frazerbilt.com

Main: 7227 A Rampart
Houston, TX 77081
Shipping: 7227 Rampart
Houston, TX 77081
Mail: P.O. Box 5000
Bellaire, TX 77402-5000

Print No. 10190 version 1 - Page 9 of 10

This drawing and all information thereon is the property of Frazer, Ltd. It is confidential and may not be reproduced or copied, whole or in part or be disclosed to others, without the specific written approval of Frazer, Ltd. It may be used solely for the purpose specified in writing and is subject to return upon demand.

DRAFT BY: WB
QC BY: AS

Victorville Fire Department - Type I - 14' Module

Interior Floor

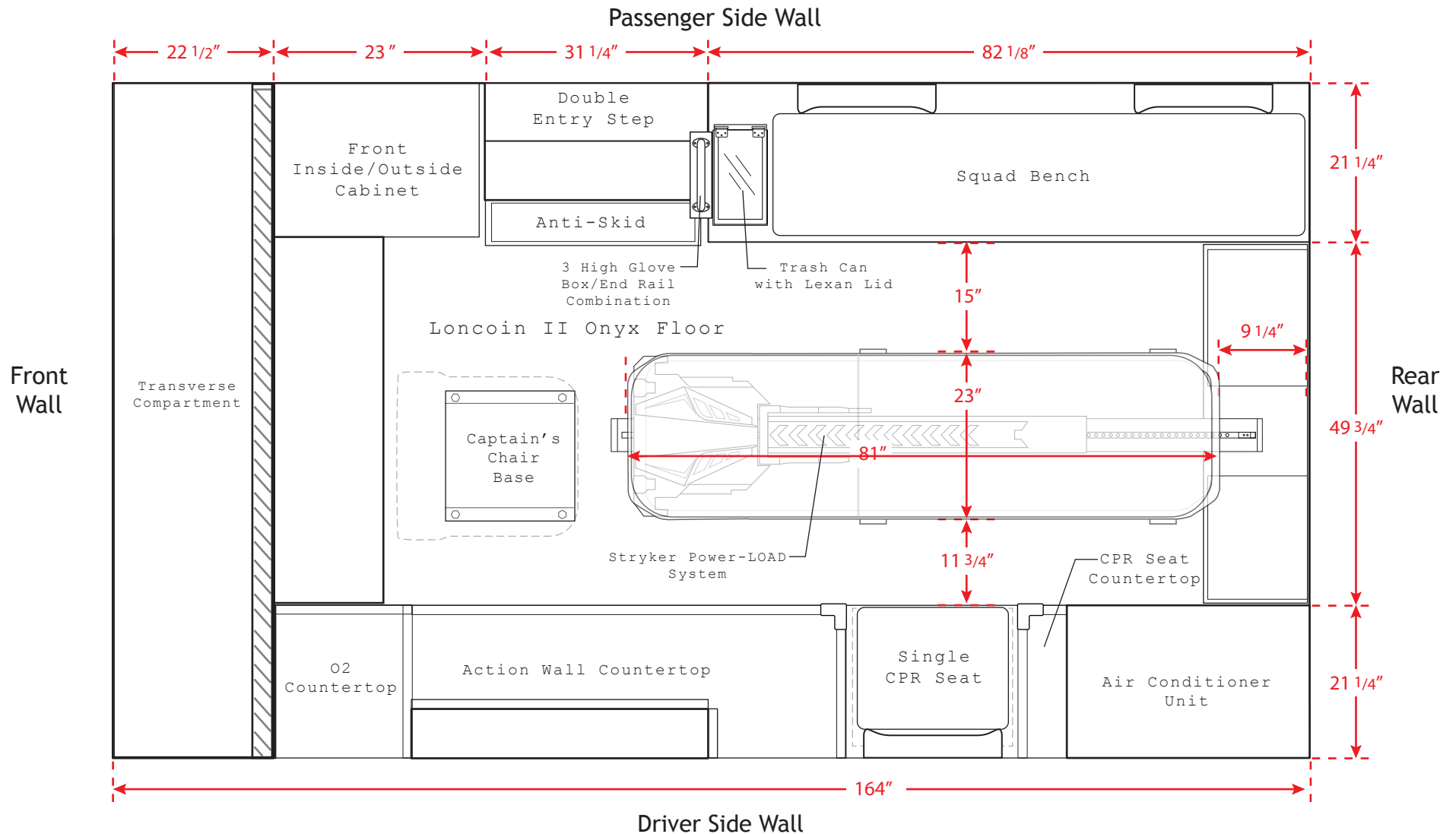

Note: Dimensions are Approximate

toll free: (888) 372-9371
 main: (713) 772-5511
 fax: (713) 995-0541
 www.frazerbilt.com

Main: 7227 A Rampart
 Houston, TX 77081
 Shipping: 7227 Rampart
 Houston, TX 77081
 Mailing: P.O. Box 5000
 Bellaire, TX 77402-5000

Print No. 10190 version 1 - Page 10 of 10

This drawing and all information thereon is the property of Frazer, Ltd. It is confidential and may not be reproduced or copied, whole or in part or be disclosed to others, without the specific written approval of Frazer, Ltd. It may be used solely for the purpose specified in writing and is subject to return upon demand.

DRAFT BY: WB
 QC BY: AS

August 16, 2023