

Attachment A

Map of CFD 01-01

AMENDMENT No. 2 **Boundaries of City of Victorville** **COMMUNITY FACILITIES DISTRICT No. 01-01** County of San Bernardino, State of California

Amendment No. 1 Of The Proposed Boundaries Map For This Community Facilities District No. 01-01 Was Recorded July 11, 2001 in Book 74 of Assessment Maps, Page 15, AND The Original Proposed Boundaries Map For This Community Facilities District No. 01-01 Was Recorded May 30, 2001 in Book 74 of Assessment Maps, Page 7, Records of Said County.

Legend

BOUNDARIES OF COMMUNITY FACILITIES DISTRICT NO. 01-01 AMENDED MAP NO. 2

27/26
34/35 SECTION CORNERS FOR T. 5 N., R. 5 W. S.B.M.

REFERENCE IS HEREBY MADE TO THE ASSESSOR MAPS OF THE COUNTY OF SAN BERNARDINO FOR AN EXACT DESCRIPTION OF THE LINES AND DIMENSIONS OF EACH LOT AND PARCEL.

ASSESSOR PARCELS LOCATED C.F.D. NO. 01-01 AMENDED MAP NO.2 :

3096-431-02	3096-611-02
3096-431-03	3096-611-03
3096-451-04	3096-631-02
3096-591-01	3096-641-05
3096-591-02	3096-691-01
3096-601-08	

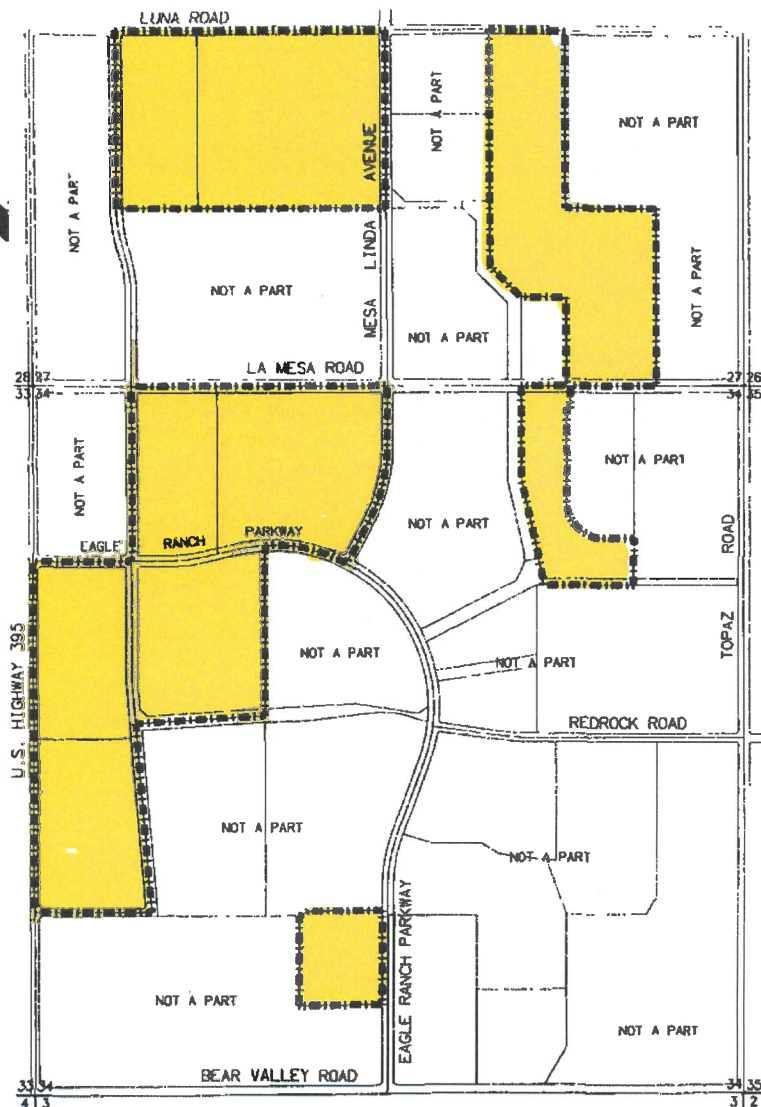

(1) FILED IN THE OFFICE OF THE CLERK OF THE CITY COUNCIL
 THIS 14 DAY OF August, 2001.
Carolee Bates
 CAROLEE BATES
 CITY CLERK, CITY OF VICTORVILLE, STATE OF CALIFORNIA

(2) I HEREBY CERTIFY THAT THE WITHIN MAP SHOWING THE PROPOSED BOUNDARIES OF THE COMMUNITY FACILITIES DISTRICT NO. 01-01 AMENDED MAP NO. 1, IN THE CITY OF VICTORVILLE, COUNTY OF SAN BERNARDINO, STATE OF CALIFORNIA, WAS APPROVED BY THE CITY COUNCIL AT A REGULAR MEETING THEREOF, HELD THIS 7th DAY OF August, 2001, BY ITS RESOLUTION NO. 01-78.
Carolee Bates
 CAROLEE BATES
 CITY CLERK, CITY OF VICTORVILLE, STATE OF CALIFORNIA



THIS MAP HAS BEEN RECORDED

20010814

FILED REQUEST OF
City of Victorville

ON August 14, 2001

AT 10:52 AM IN

BOOK 74 PAGE 19

OF Assessment Maps

SAN BERNARDINO COUNTY RECORDER

FEE \$ 7.00